



5/16" BORE STAINLESS STEEL CYLINDER

SSR-05-□-□

Single Acting

Mount: Stud
Type: Rotating Rod
Options: B, V, S, N

Standard Stroke Lengths: 1/2", 1", 1-1/2", 2", 3", 4"
Spring Compressed: 1 lbs. **Spring At Rest:** 0.5 lbs.
Maximum Stroke: 29"

For B option add 0.250

For S option add 0.220

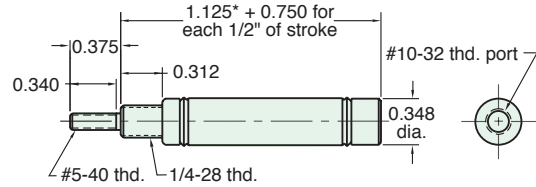

Nut included, but not shown on drawing

USR-05-□-□

Single Acting

Mount: Universal
Type: Rotating Rod
Options: B, V, N, P6

Standard Stroke Lengths: 1/2", 1", 1-1/2", 2", 3", 4"
Spring Compressed: 1 lbs. **Spring At Rest:** 0.5 lbs.
Maximum Stroke: 29"

For B option add 0.250

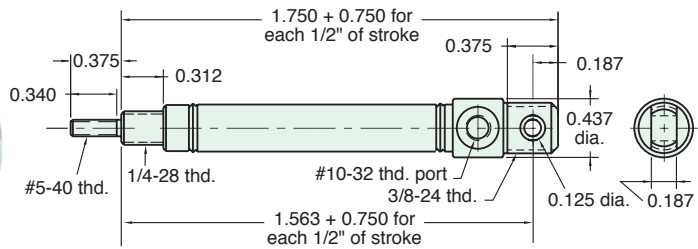

Nuts included, but not shown on drawing

SDR-05-□-□

Double Acting

Mount: Stud
Type: Rotating Rod
Options: B, V, P6, P7, P8, S, N

Standard Stroke Lengths: 1/2", 1", 1-1/2", 2", 3", 4"
Maximum Stroke: 43"

For B option add 0.250

For S option add 0.220

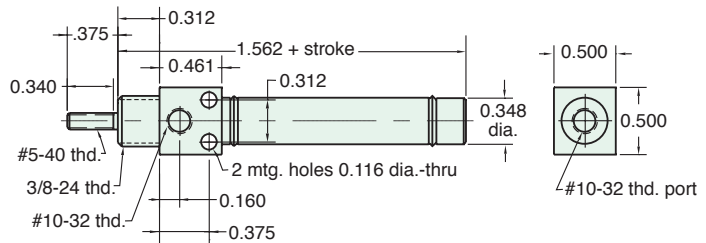

Nut included, but not shown on drawing

UDR-05-□-□

Double Acting

Mount: Universal
Type: Rotating Rod
Options: B, V, P2, P3, P4, P5, P6, P7, P8, N

Standard Stroke Lengths: 1/2", 1", 1-1/2", 2", 3", 4"
Maximum Stroke: 43"

For B option add 0.250

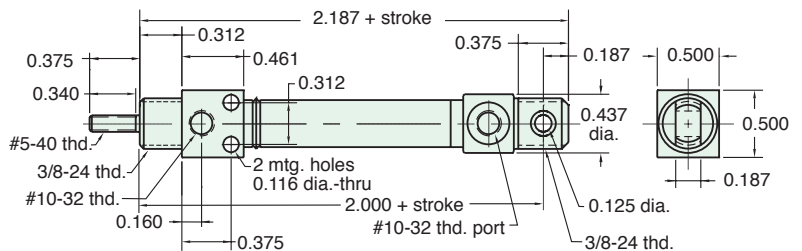

Nuts included, but not shown on drawing